

Technical Data Sheet

Korff Type 170 EXPRESS

/ range $\Phi 10,2$ do $\Phi 1219$ /

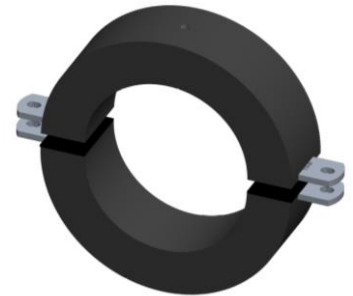

Description	Heavy duty refrigeration pipe ring with integrated elastomeric seal
Intended use	Thermal insulation, load carrying element
	Application:
	<ul style="list-style-type: none"> • Pipelines • Machine elements • Petroleum • Chemical

Parameter	Value	Unit	Standard / test result
Insulation material	Polyurethane foam with elastomeric seal	-	-
Colour	Black	-	-
Density /insulation core/	250	kg/m ³	EN 1602
Reakcja na ogień			
Product	B2	class	DIN 4102 H-005/19
Thermal conductivity coef.	0.044 at 0 deg C	W/m/K	EN 12667c / F.2-3659/12
Water vapour resistance	2.6*10** ⁻¹⁰ $\mu = \text{ca. } 1400$	kg/h-r/Pa -	EN 13469/ R-18/14
Compression strength / PU foam/	4.3	MPa at 23 deg C	EN 826 / L2-3d/2013
Temperature range of assembly / storage	+5 - +40	Deg C	-
Temperature range of application	Product: -50 - +105 PU Foam- -180 - +110	deg C	-
Thread connections	Metric	-	ISO 13-1
Hanging configuration	In hanging configuration – installation on two threaded rods for nominal dimension 219-40 and bigger is required		DIN 975 EN 4032
	The clamp holding the pipe is to be affixed with bolts/threaded rods to the structure carrying the load		
	Fasteners not included in the commercial set recommended fasteners		ISO 4034 DIN 975 EN 4032
Permissible load			
Radial load			
Compression strength allowable /dynamic load/	<ul style="list-style-type: none"> • $\sigma_d = 0.6$ 	MPa	

Calculated supporting area	• A_{ef} – effective area supporting pipe	Mm**2	
Permissible load	• $Fr = A_{ef} * \sigma_d * 10^{**3}$	kN	
Technical drawing			
Technical drawing		-	-

Designations used in the table	<ul style="list-style-type: none"> • D_R – pipe diameter • Fr – load • Fr_cat – catalogue load value • CP connection piece • D1 – outer diameter • B – length • GI - nominal insulation thickness • CB – bolts • L1 – total length • L2 – bolts spacing 	mm kN kN - mm mm mm - mm mm	
--------------------------------	---	--	--

Nominal dimension	D_R	Fr	Fr_cat	CP	D1	B	GI	CB	L1	L2
10-30	10,2	0,27	0,2	M8	90	50	30	M6	126	108
13-30	12,7	0,33	0,3	M8	90	50	30	M6	126	108
16-30	16	0,42	0,4	M8	90	50	30	M6	126	108
17-30	17,2	0,45	0,4	M8	90	50	30	M6	126	108
18-30	18	0,47	0,4	M8	90	50	30	M6	126	108
21-30	21,3	0,55	0,5	M8	90	50	30	M6	126	108
22-30	22	0,57	0,5	M8	90	50	30	M6	126	108
25-30	25,4	0,66	0,6	M8	90	50	30	M6	126	108
27-30	26,9	0,7	0,6	M8	90	50	30	M6	126	108
28-30	28	0,73	0,7	M8	90	50	30	M6	126	108
34-30	33,7	0,88	0,8	M8	100	50	30	M6	136	118
35-30	35	0,91	0,9	M8	100	50	30	M6	136	118
42-30	42,4	1,1	1,1	M8	110	50	30	M6	146	128
48-30	48,3	1,25	1,2	M8	110	50	30	M6	146	128
54-30	54	1,4	1,4	M8	124	50	30	M6	158	140
57-30	57	1,48	1,4	M8	124	50	30	M6	158	140
60-30	60,3	1,57	1,5	M8	124	50	30	M6	158	140
64-30	63,5	1,65	1,6	M8	124	50	30	M6	158	140
76-30	76,1	1,98	1,9	M8	137	50	30	M10	203	359
89-30	88,9	2,31	2,3	M8	150	50	30	M10	211	359
108-30	108	3,37	3,3	M10	168	60	40	M10	230	359
114-40	114,3	3,56	3,5	M12	193	60	40	M10	230	359
133-40	133	4,15	4,1	M12	214	60	40	M10	300	359
139-40	139,7	4,36	4,3	M12	217	60	40	M10	300	359
159-40	159	4,96	4,9	M12	239	60	40	M10	319	359
168-40	168,3	5,25	5,2	M12	253	60	40	M10	328	359
180-60	180	9,35	9,3	M12	300	100	40	M12	399	359
219-40	219,1	11,38	11,3	M12	300	100	40	M12	399	359
219-60	219,1	11,38	11,3	M12	340	100	60	M12	439	399
254-40	254	13,2	13,1	M16	353	100	40	M16	453	413
254-60	254	13,2	13,1	M16	393	100	60	M16	493	453
267-40	267	13,87	13,8	M16	353	100	40	M16	453	413
267-60	267	13,87	13,8	M16	393	100	60	M16	493	453
273-40	273	14,19	14,1	M16	353	100	40	M16	453	413
273-60	273	14,19	14,1	M16	393	100	60	M16	493	453
324-40	323,9	16,83	16,8	M20	406	100	40	M16	544	504
324-60	323,9	16,83	16,8	M20	448	100	60	M16	576	536
356-40	355,6	18,48	18,4	M20	477	100	60	M16	536	494
356-60	355,6	18,48	18,4	M20	477	100	60	M16	576	536
368-60	368	22,95	22,9	M20	492	120	60	M16	588	548

Korff Isolmatic Sp. z o.o., ul. Lotnicza 12, Wojnarowice, PL 55-050 Sobótka 1

406-40	406,4	25,34	25,3	M24	486	120	40	M16	606	556
406-60	406,4	25,34	25,3	M24	530	120	60	M16	646	596
457-60	457,2	28,51	28,5	M24	578	120	60	M16	697	647
508-60	508	31,68	31,6	M24	635	120	60	M16	748	698
609-60	609,6	44,35	44,3	M24	731	140	60	M16	848	798
711-60	711,2	51,74	51,7	M24	831	140	60	M16	961	911
813-60	812,8	59,13	59,1	M24	933	140	60	M20	1086	1026
914-60	914	66,49	60	M24	1036	140	60	M20	1186	1126
1016-60	1016	73,91	60	M24	1138	140	60	M20	1288	1228
1067-60	1067	77,62	60	M24	1189	140	60	M20	1339	1279
1118-60	1118	81,33	60	M24	1240	140	60	M20	1390	1330
1219-60	1219	88,68	60	M24	1341	140	60	M20	1491	1431

* Other sizes available, nominal size - does not mean physical dimensions, Fr - radial load

PM, 2019-11-27

The data provided on the basis of the state of knowledge at the time of issue. The data given in good faith, but are not legally binding one. We reserve the right to change the specification.